

TECHNICAL DATA

Aluminum profile for fixing glass

reference number : AF763

profile

Size: 12x8x2500 mm
12x13x2500 mm

Thickness: 0.8 mm
1.3 mm

(There may be slight size differences)

CH01370047	Af763-4M-12H-13W Black Matt 1.3 X 2500 - 016047	Black Matt
CH01370050	Af763-4M-12H-9W Black Matt 0.8 X 2500 - 016050	Black Matt
CH01370046	Af763-2M-12H-13W Gold Matt 1.3 X 2500 - 016046	Gold Matt
CH01370049	Af763-2M-12H-9W Gold Matt 0.8 X 2500 - 016049	Gold Matt
CH01370045	Aluminium Profile 1.3 X 2500 Silver Matt - 016045	Silver Matt
CH01370048	Af763-1M-12H-9W Silver Matt 0.8 X 2500 - 016048	Silver Matt

description	Standard
Length	2500 mm
Width	13 - 8 mm
Thickness	0.8 - 1.0 mm
Material	Aluminum
Fire resistance	UNE 23-727-90
Appearance and color	EN 12373-1
Lightfastness	Excellent

Installation :

It's widely applied for fixing shower glass of tile, or stone, wooden laminated, boards and decorative material.

1. Cut profile to the desired length and apply the adhesive on the support where the profile will be laid.
2. Remove carefully any remains of oil, fat and dirt from the surface where the profile will be laid.
3. Apply the adhesive to the surface of the substrate.
4. Insert the glass into the profile that is between the tile or (wood board or stone, etc.).
5. Start installing the floor or wall tiles above the profile.
6. Remove immediately all the remains of grout from the surface of the profile and tile (wood board, door or stone, etc.).

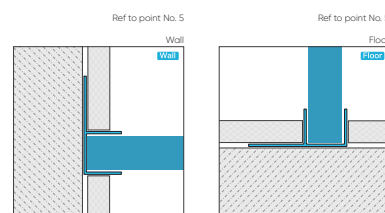

Cleaning and maintenance :

The product must be cleaned periodically with a soft mop. If you use a neutral liquid cleaner, you must rinse the profile with cold water and dry it to remove the humidity excess. The persistent dirtiness can be removed by using cleaning approved agents lightly abrasive or a grid covered with polished powder neutral. Steel wool, abrasive cleaners, souring products as well as strong acids (hydrochloric and perchloric), strong bases (caustic soda or ammonia) or carbonated solutions are not recommended. Citric acid is neither recommended because it dissolves the protective layer of the surface of aluminum. Waxes, petrolatum, lanolin or similar substances are not appropriate. Solvents containing haloalkanes (hydrofluoroether and chlorinated solvents) and curing accelerators containing chlorides should not be used (use special accelerators free of chlorides)

Checked By QUALITY DEPARTMENT

occupational health and safety
GB/T45001-2020/ISO 45001:2018



Quality Management System ISO 9001

